

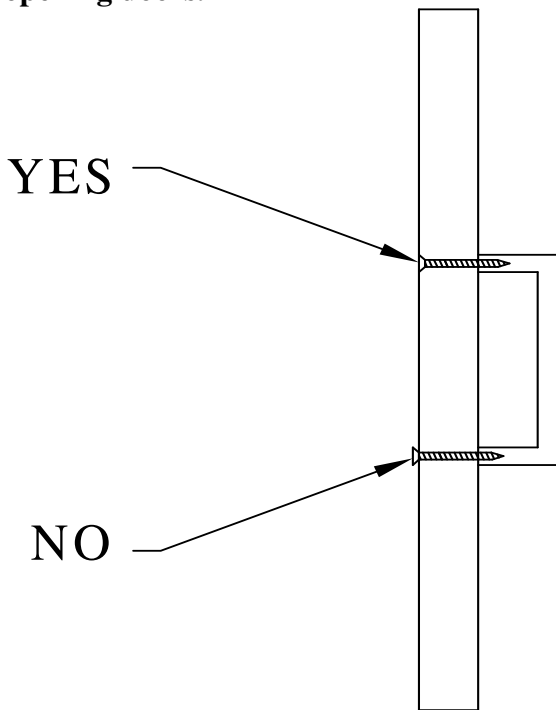

Pie Cut Instructions

Recommended Hardware Installation:

Countersink all screws to prevent frame or adjacent cabinet damage when closing or opening doors.



Toe Kick Assembly:

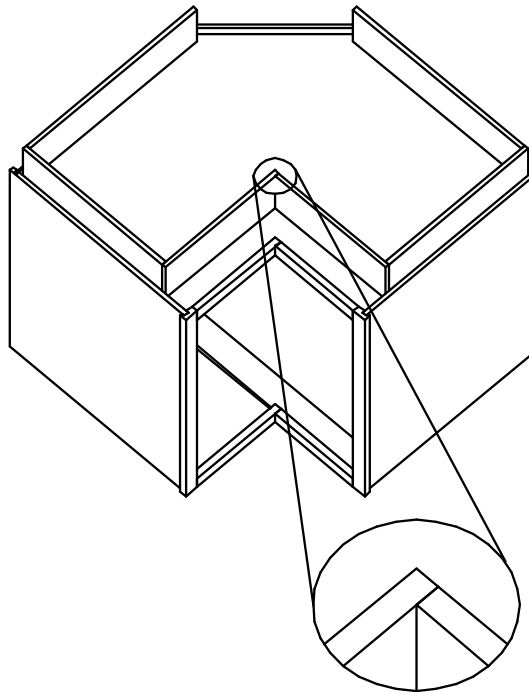

1. Remove doors and adjustable shelves.
2. Turn Cabinet upside down.
3. Place both sections of toe kick as shown, with triangular corner blocks against the floor of the cabinet. Then screw through the 1/2" corner supports into the cabinets' floor using 1" pan head screws.
4. The shorter "legs" of both sections should be 90 degrees to each other.
5. The longer "legs" of the two sections are placed against the backs of the cabinet, as close to the rear corner as possible.
6. The section's two short legs butt together as shown in the magnification.
7. Attach the two sections together with small nails or staples at this joint if needed.
8. Stand cabinet to upright position and reinstall shelves and doors.